

DETALHE MEZANINO - PILARES
ESC: 1/50

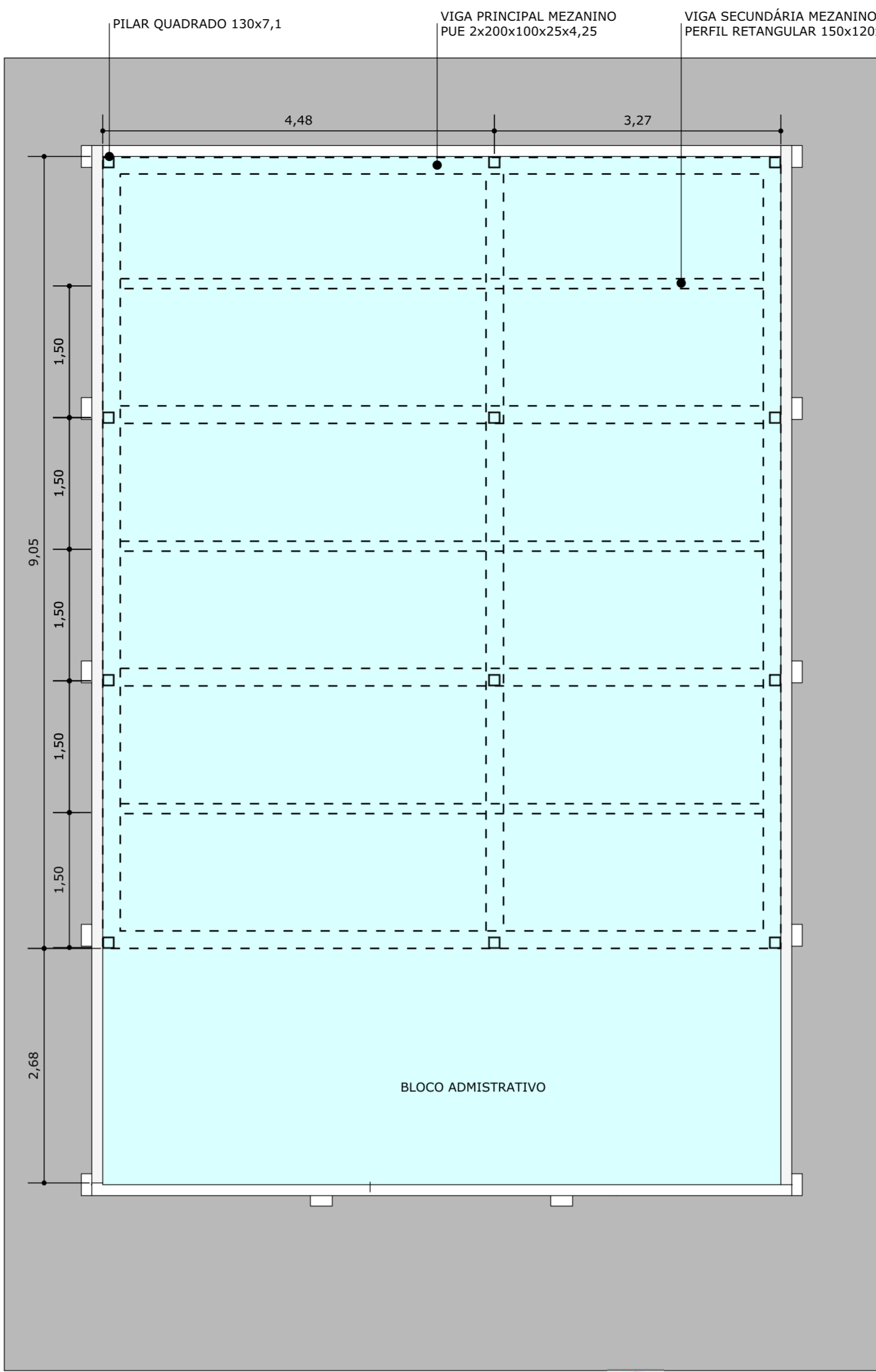

DETALHE MEZANINO - PILARES
ESC: 1/50

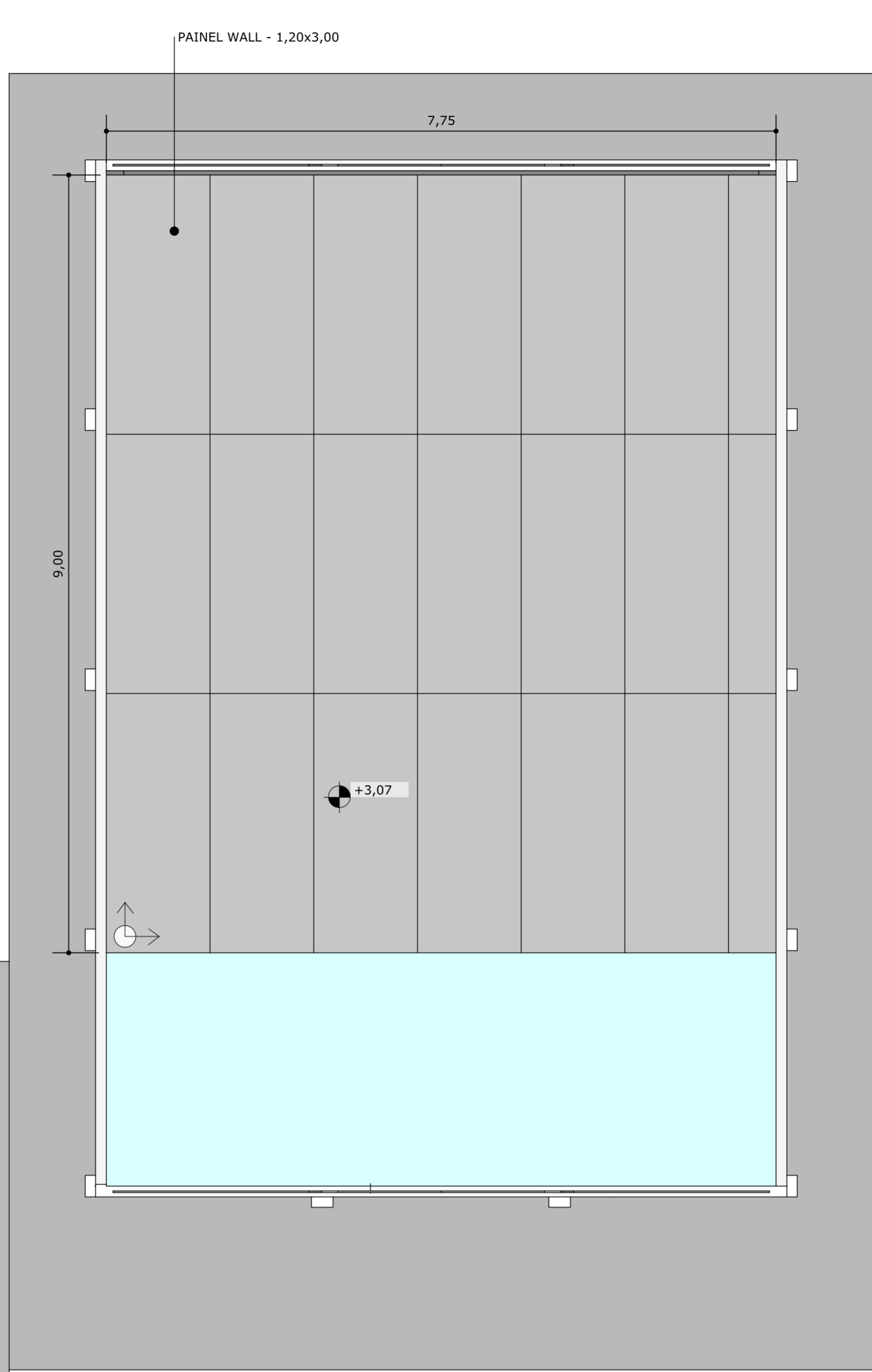

DETALHE MEZANINO - PAINEL WALL
ESC: 1/50

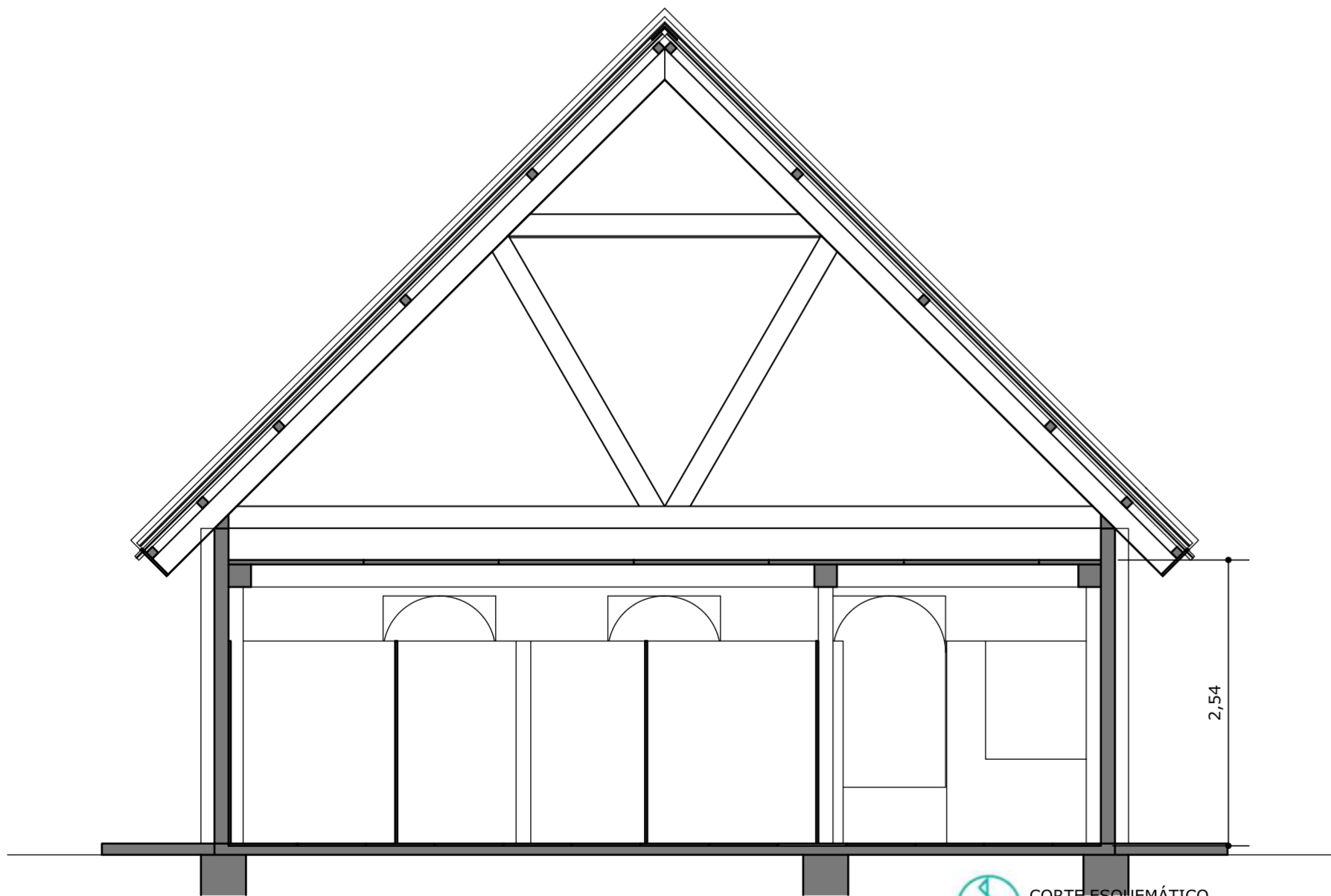







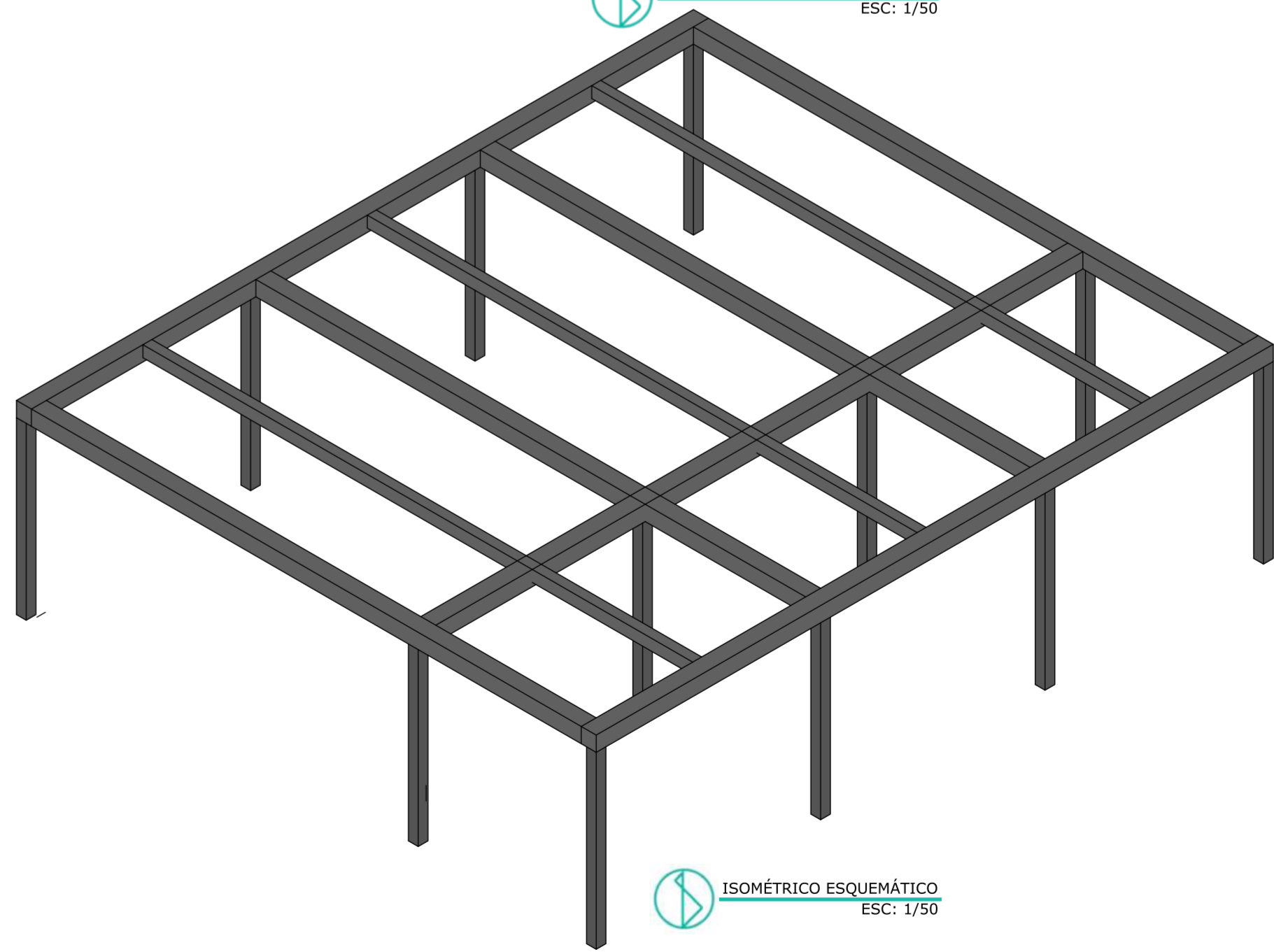





CORTE ESQUEMÁTICO
ESC: 1/50



PLANTA CHAVE LOCALIZAÇÃO
ESC: 1/250



ISOMÉTRICO ESQUEMÁTICO
ESC: 1/50





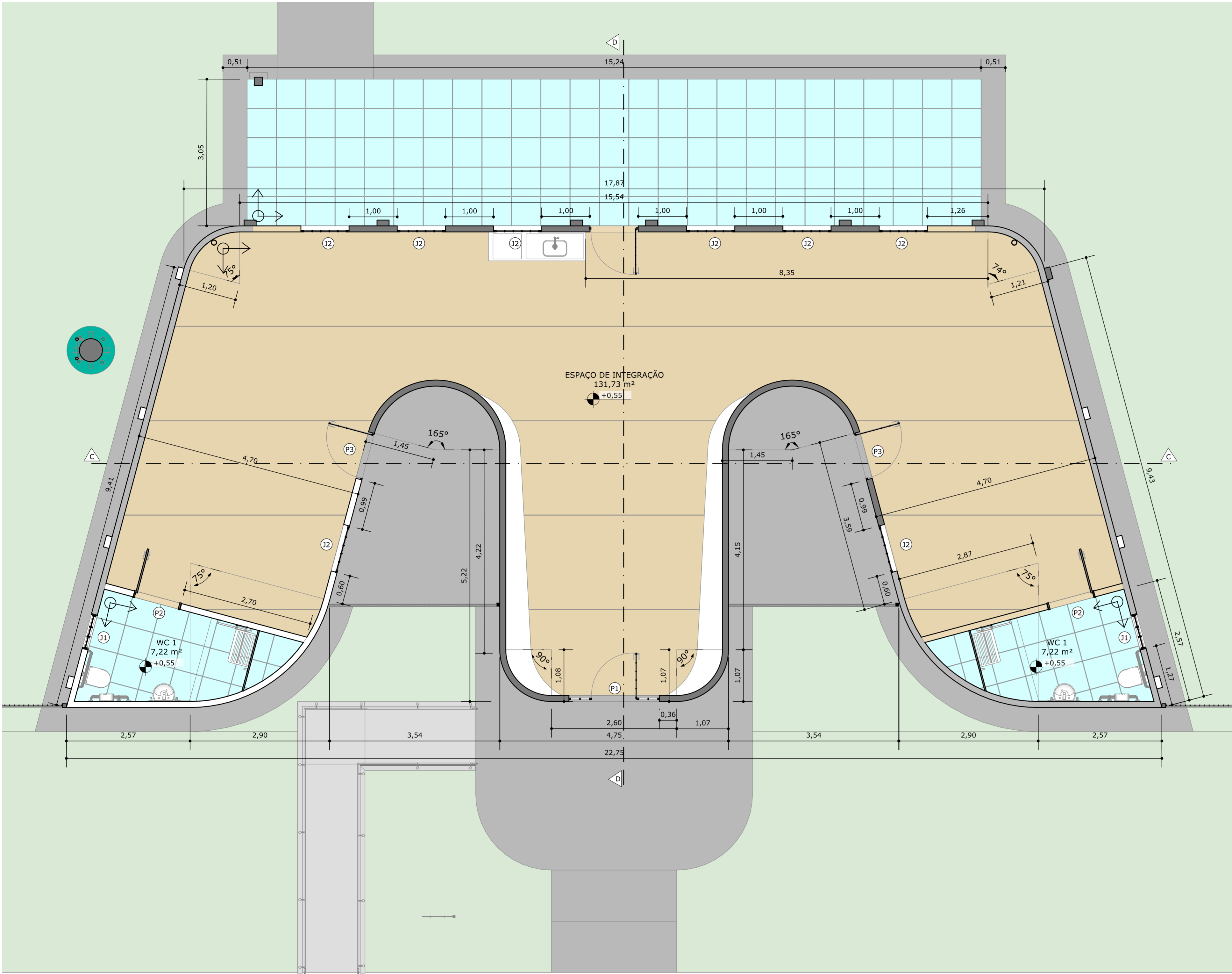

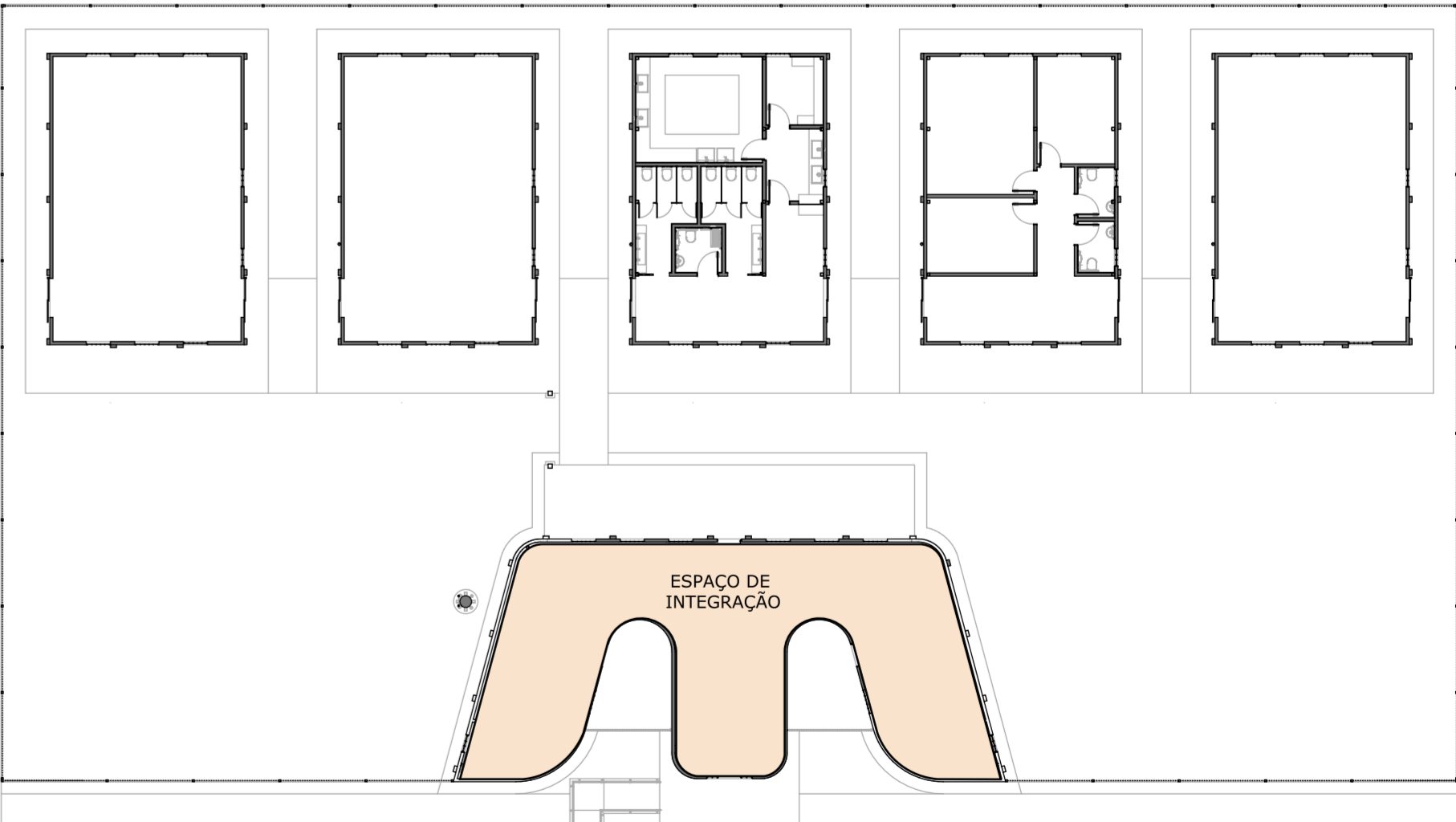

LEGENDA	
	MANTA VINÍLICA COM TEXTURA DE MADEIRA
	PORCELANATO ACETINADO 60x60 - CIMENTO QUEIMADO
	PISO MONOLÍTICO DE CONCRETO
	GRAMA - ÁREA PERMEÁVEL
	TIJOLO ECOLÓGICO 12,5x25
	DRYWALL COM PLACA CIMENTÍCIA 13 cm
	FECHAMENTO COM GRADIL NYLOFOR h: 2,50 m
	FECHAMENTO COM GRADIL NYLOFOR h: 1,03 m
	PILAR QUADRADO 130x7,1 mm
	GRELHA METÁLICA
	REVESTIMENTO 60x120 - h: 1,80 m
	INICIO PAGINAÇÃO DE PISO

OBRA:	PROJETO VIVA		
LOCAL:	VILA VALÉRIO - ES	CONTEÚDO PLANTA MEZANINO - BLOCO ADMINISTRATIVO E COZINHA	
RESP. TÉCNICO	ALESSANDRO RODRIGUES BATISTA CAU: 00A633054	ESC: Indicada	DATA: nov, 2022
		PRANCHA: 06 / 16	REV: R0



ESPAÇO DE INTEGRAÇÃO		
DESCRIÇÃO DO SERVIÇO	UNIDADE	QUANTIDADE
CONTRAPISO 4cm	m²	155,24
MANTA VINÍLICA LINHA OMNISPORTS BEACH 2x20,5 m	m²	131,73
PORCELANATO ACETINADO 60x60 CIMENTO QUEIMADO	m²	14,44
MANTA ASFÁLTICA AUTO ADESIVA ALUMINIZADA	m²	3,2
RUFO METÁLICO	m	78,17
CHAPIM METÁLICO	m²	78,17
FORRO EM MADEIRA	m	164,94
FECHAMENTO EM RIPADO DE MADEIRA	m²	22,74
FECHAMENTO DE TELA EXPANDIDA FACHADA	m²	2,86
PINTURA ACRÍLICA BRANCA	m²	138,8
TUBO DE QUEDA EM PVC BRANCO Ø: 100mm	m	8
GRANITO POLIDO SÃO GABRIEL	m²	1,34
Cuba em Aço Inox Polido 47X30cm, Tramontina, 94083507	unid.	1
Torneira Cozinha Gourmet Monocomando Com Spray Extensor	unid.	1
VASO SANITÁRIO COM VALVULA DE DESCARGA	unid.	2
TORNEIRA DE MESA PARA BANHEIRO	unid.	2
Lavatório Spot Deca L.39.17	unid.	2
Chuveiro Docol Eden 00985606 de Parede com Desviador 1/2, Cromado	unid.	1
Assento Banco Articulado Aço Inox 70 X 45 Cm	unid.	1



LEGENDA					
	MANTA VINÍLICA COM TEXTURA DE MADEIRA		TIJOLO ECOLÓGICO 12,5x25		GRELHA METÁLICA
	PORCELANATO ACETINADO 60x60 - CIMENTO QUEIMADO		DRYWALL COM PLACA CIMENTÍCIA 13 cm		REVESTIMENTO 60x120 - h: 1,80 m
	PISO MONOLÍTICO DE CONCRETO		FECHAMENTO COM GRADIL NYLOFOR h: 2,50 m		INICIO PAGINAÇÃO DE PISO
	GRAMA - ÁREA PERMEÁVEL		FECHAMENTO COM GRADIL NYLOFOR h: 1,03 m		
			PILAR QUADRADO 130x7,1 mm		

PLANTA COTADA
ESC: 1/50

PLANTA CHAVE LOCALIZAÇÃO
ESC: 1/250

OBRA:	PROJETO VIVA	AMÉRICA LATINA ENGENHARIA	
LOCAL:	VILA VALÉRIO - ES		
RESP. TÉCNICO	ALESSANDRO RODRIGUES BATISTA CAU: 00A633054	CONTEÚDO	
ESC:	DATA:	PRANCHA:	REV:
Indicada	nov, 2022	07 / 16	R0



VISTA FRONTAL
ESC: 1/50

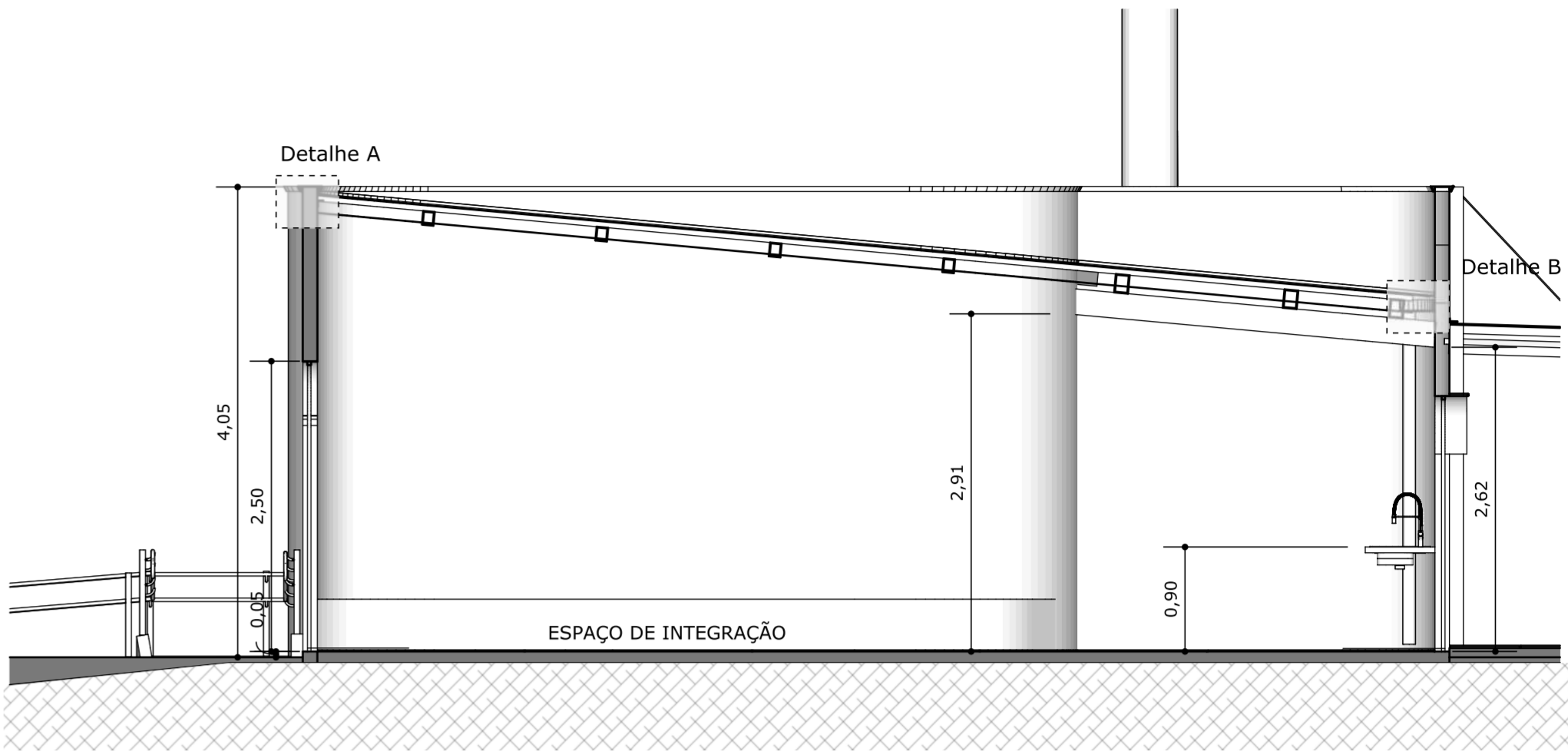

CORTE DD
ESC: 1/50

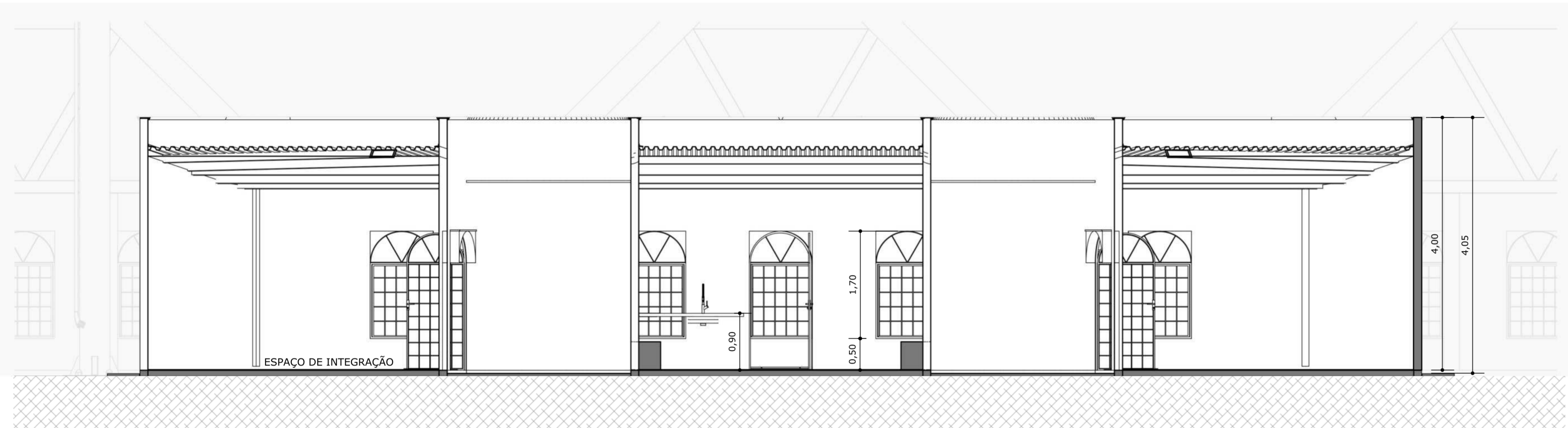

CORTE CC
ESC: 1/50

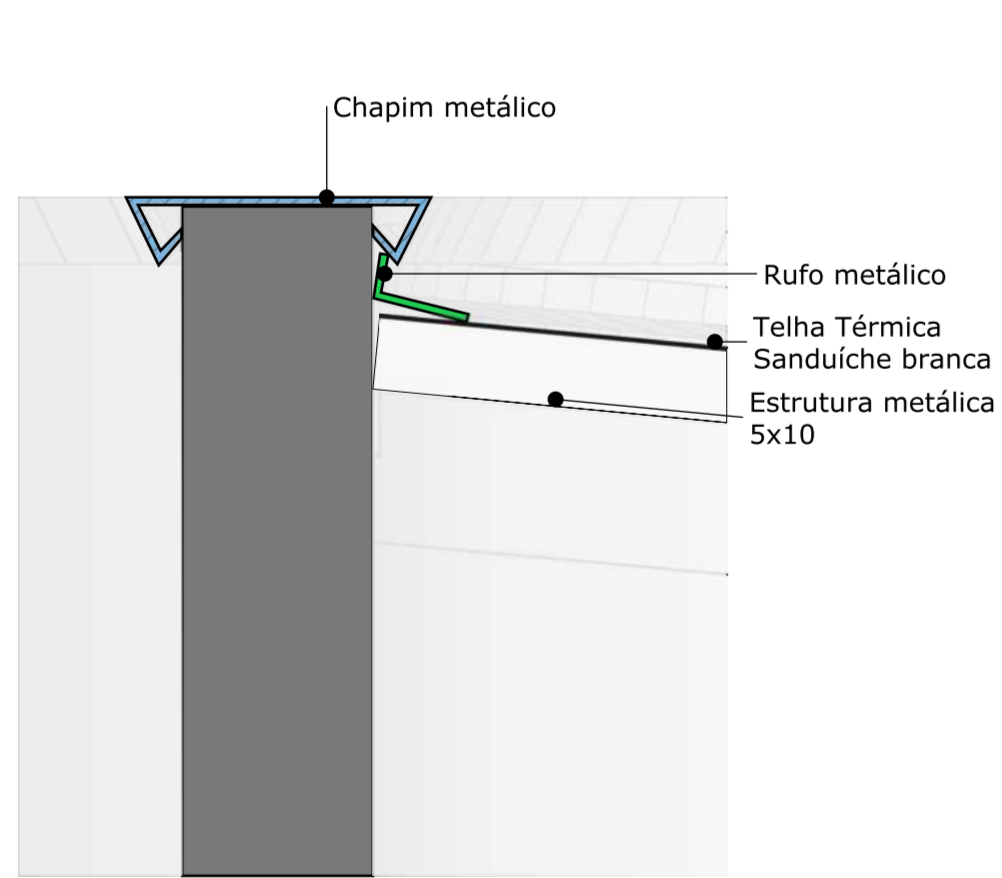

DETALHE A
ESC: 1/5

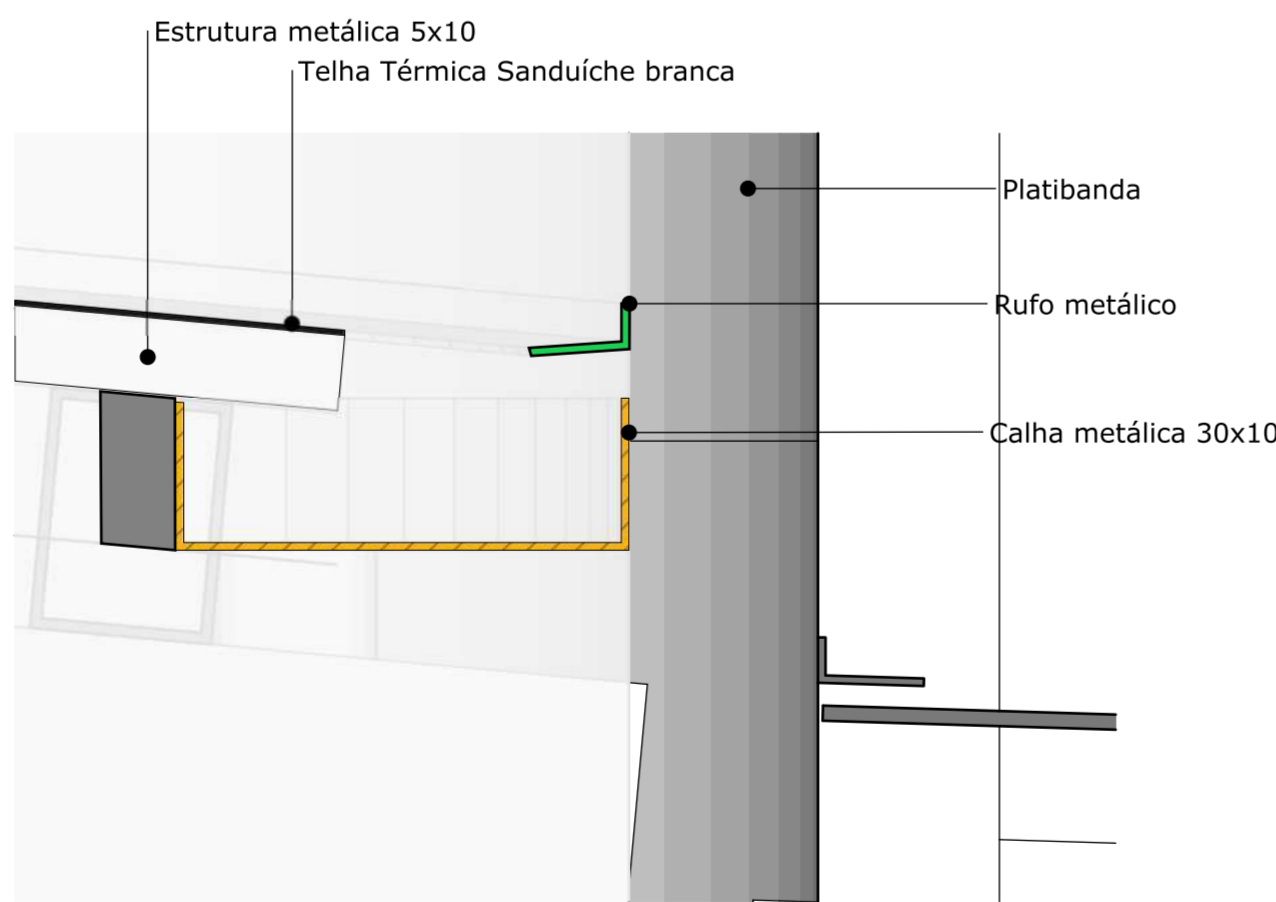

DETALHE B
ESC: 1/5

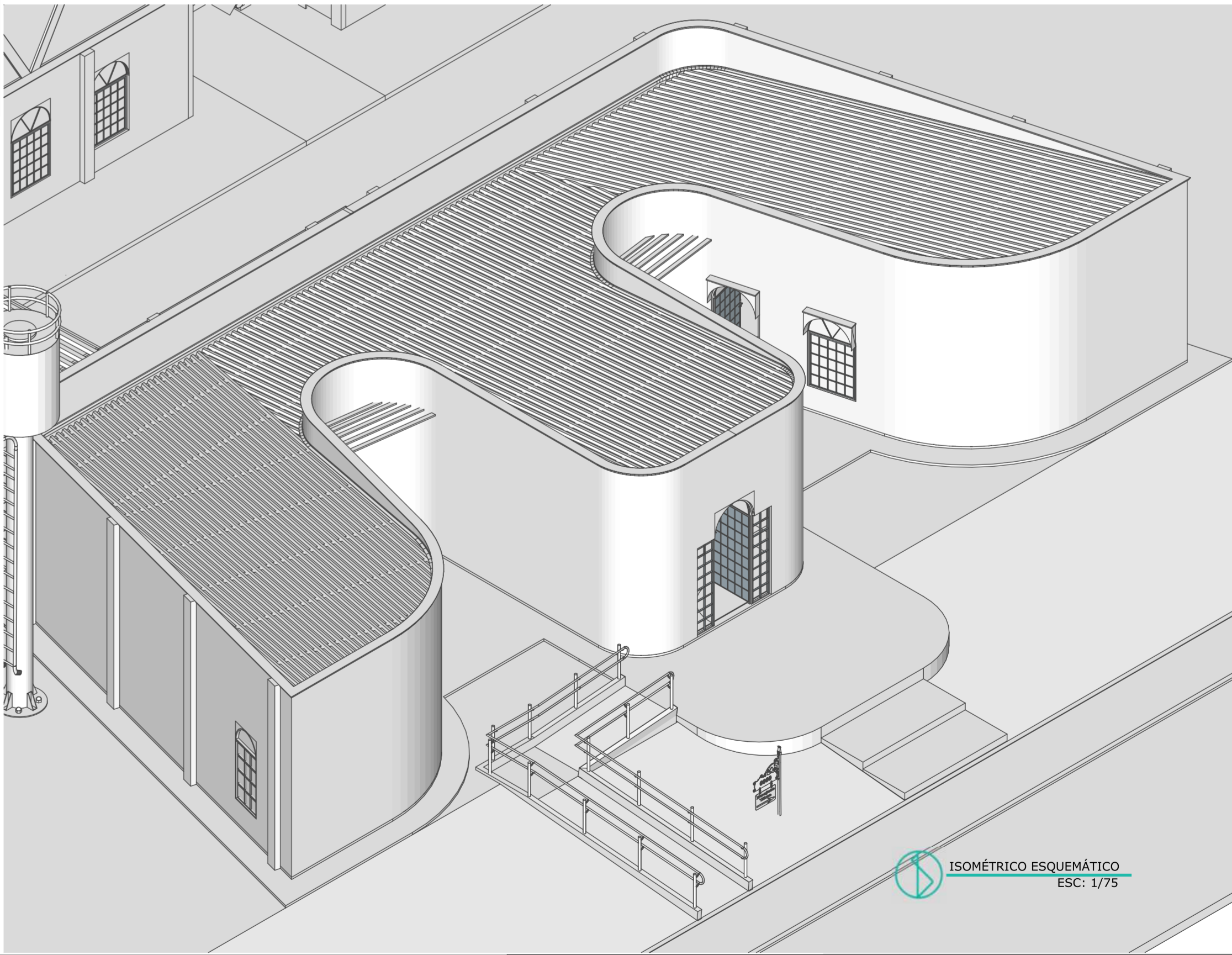

ISOMÉTRICO ESQUEMÁTICO
ESC: 1/75

OBRA:	PROJETO VIVA				
LOCAL:	VILA VALÉRIO - ES	CONTEÚDO CORTES E ISOMÉTRICOS ESPAÇO DE INTEGRAÇÃO			
RESP. TÉCNICO	ALESSANDRO RODRIGUES BATISTA CAU: 00A633054	ESC:	DATA:	PRANCHA:	REV:
		Indicada	nov, 2022	08 / 16	R0